

Winterization (Cont)

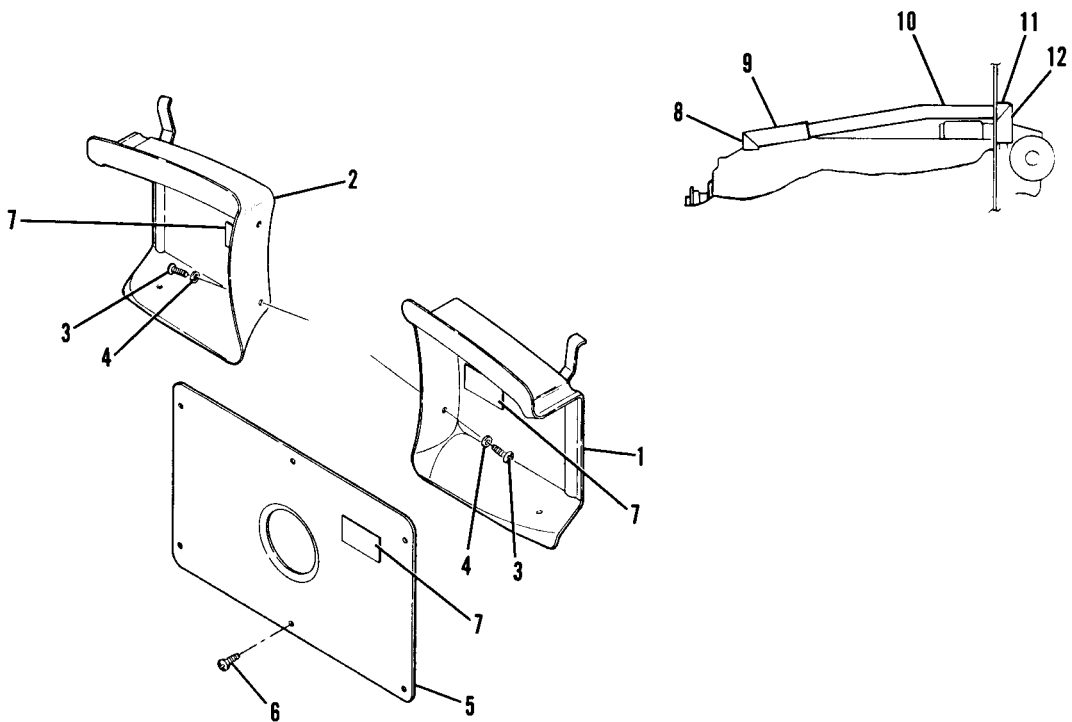

Figure 71. Winterization Equipment Installation

FIGURE AND INDEX NO.	PART NUMBER	DESCRIPTION	UNITS PER ASSY	USABLE ON CODE
		1 2 3 4 5 6 7		
71 -		WINTERIZATION EQUIPMENT INSTALLATION -----	NP	A
- 1	0752647-5	COVER-WINTER FRONT LH -----	1	B
	0752647-9	COVER-WINTER FRONT LH -----	1	C
- 2	0752647-6	COVER-WINTER FRONT RH -----	1	B
	0752647-10	COVER-WINTER FRONT RH -----	1	C
		ATTACHING PARTS -----		
- 3	AN520-10R10	SCREW -----	3	
- 4	AN960-10L	WASHER -----	3	
	NAS680A3	NUT -----	3	
		-----*		
- 5	0752641-7	COVER ASSY-FILTER -----	1	B
	0752641-1	COVER ASSY-FILTER -----	1	C
		ATTACHING PARTS -----		
- 6	AN509-10R8	SCREW -----	6	
		-----*		
- 7	SEE FIG 2	PLACARD-WINTERIZATION -----	3	
- 8	1200191-4	TUBE-WINTERIZATION -----	1	
- 9	1200191-5	TUBE-WINTERIZATION -----	1	
-10	1200191-6	TUBE-WINTERIZATION -----	1	
-11	1200191-7	TUBE-WINTERIZATION -----	1	
-12	1200191-8	TUBE-WINTERIZATION -----	1	
		A---182 SERIAL 18262466 & ON		
		B---182 SERIAL 18262466 THRU 18263475		
		C---182 SERIAL 18263476 & ON		